



DELTA ELECTRONICS, INC.

# Newsletter



## New Product Launch Announcement

### Preface :

VFD-USB01 is a convenient RS-485-to-USB converter which requires no additional power-supply and complex setting process. VFD-USB01 supports wide-ranging baud rate of 75~115.2k bps, automatically switching data exchange direction, adopts RJ-45 as RS-485 connector. Its tiny dimension and handy use of plug-and-play provides another great option while connecting all DELTA products with your PC.

### Table of Content :

VFD-USB01

Preface \ Content .....	1
Appearance \ Applicable Model .....	2
ApplicationI .....	2
Specifications .....	3
Dimension .....	3
Ordering information .....	4
Expected release date .....	4

## Introduction

### VFD-USB01



Appearance

- Applicable Model : All DELTA products
- Application



## New Product Launch Announcement

### ■ Specifications

<b>Power Requirement</b>	No external power supply necessary
<b>Power Consumption</b>	0.4W
<b>Isolated Voltage</b>	3000 Vdc
<b>Baud Rate</b>	Support 75, 150, 300, 600, 1200, 2400, 4800, 9600, 19200, 38400, 57600, 115200 bps
<b>RS-485 terminal mode</b>	RJ-45
<b>USB Connector</b>	B type(female)
<b>Input Impedance</b>	96 kΩ
<b>Commpatbiliay</b>	Full Compliance with USBV1.1 specification

### RJ45 Pin

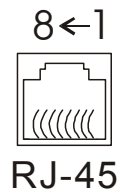

PIN	Signal Name
1	Reserved
2	Reserved
3	Reserved
4	SG+
5	SG-
6	Reserved
7	Reserved
8	Reserved

### Dimension

## New Product Launch Announcement

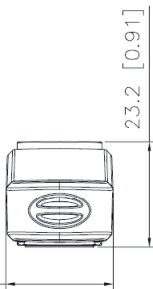
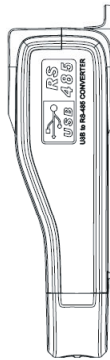
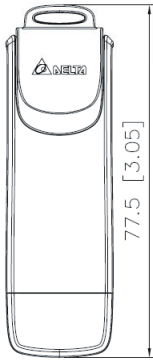

UNIT: mm(inch)

### Ordering information

Item	Specification	Model
USB/RS485	USB/RS485 transformer	VFD-USB01

### Expected Release Date

Model	Date
VFD-USB01	April/2007